

---

**University of Regina**  
**2016 Campus Master Plan Update**  
**Phase 2: Principles and Explorations**  
September 22, 2015

---

**dtah**

---

# **Agenda - Phase 2 Engagement**

**Purpose of Session**

**Review of May Engagement/What We Heard**

**Revised Overall Principles**

**Site Specific Explorations**

**Breakout Session + Report Back**

**Summary/Conclusion**

**Next Steps**

# Work Plan Schedule



2006-2015 Projects Revise Site Plan Modify Digital Model	Updated Principles Site Plan Options Updated Model	Principles Demonstration Plan Digital Model Draft Report	Final Draft Report
Presentation Materials	Presentation Materials	Presentation Materials	WCA Board and Committee Submission
Phase 1 Engagement May 2015	Phase 2 Engagement September 2015	Phase 3 Engagement November 2015	WCA Board Approval February 2016

Board of Governors  
Presentation  
December 2015

# Campus in the City

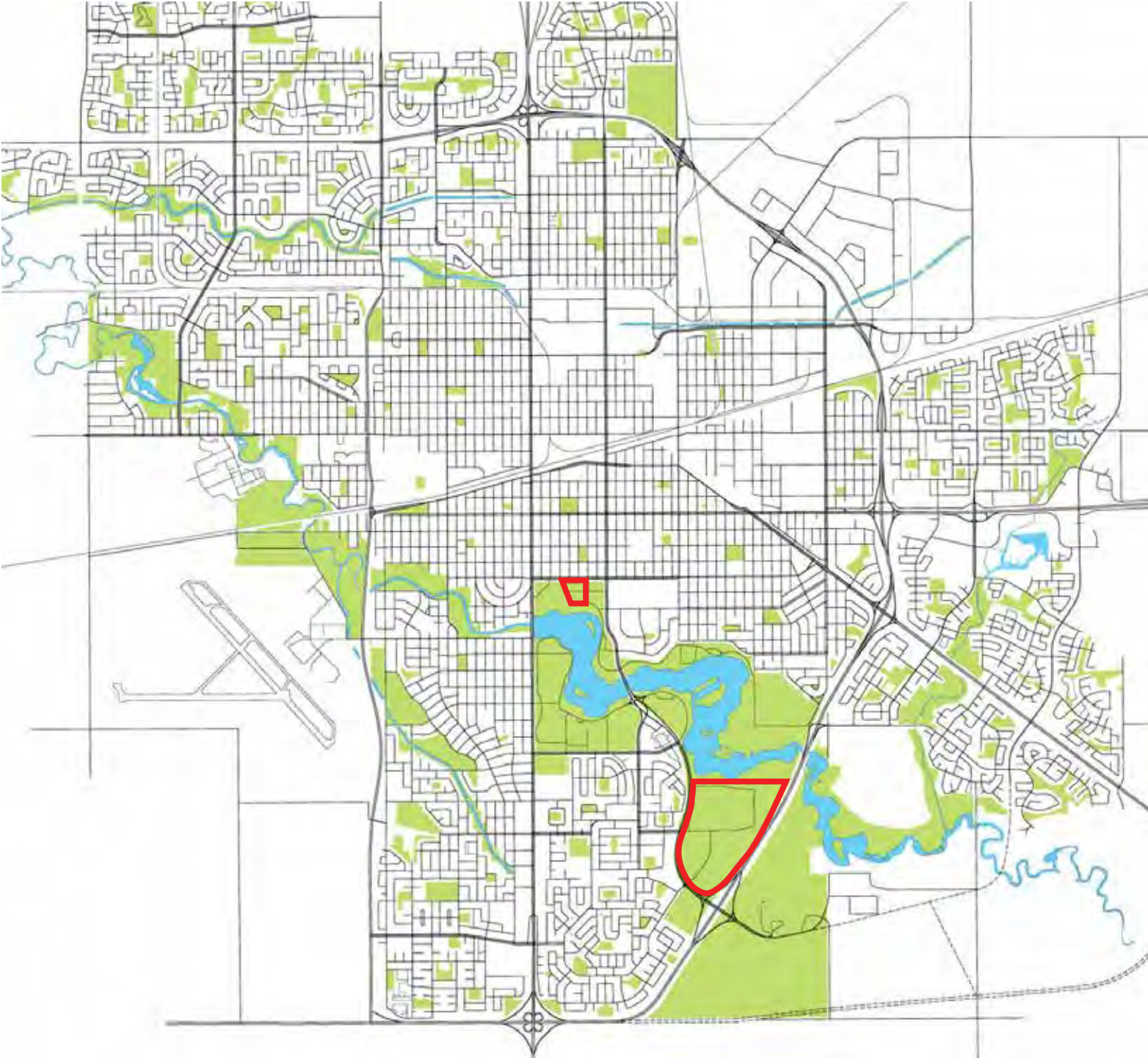

# Campus in Wascana Centre



# May Engagement: What We Heard

## Key Messages

### A Landscape Campus

The exterior spaces of campus landscape are highly valued and are part of the university's identity

Strong interest in prairie and prairie-like landscapes

### Links + Connections

Weather protected connections highly desired for entire campus

### Parking

On-going challenges to provide surface parking as the campus develops and intensifies over time



University of Regina Campus Master Plan Update >  
Phase 2 Engagement  
**Revised Landscape Principles**

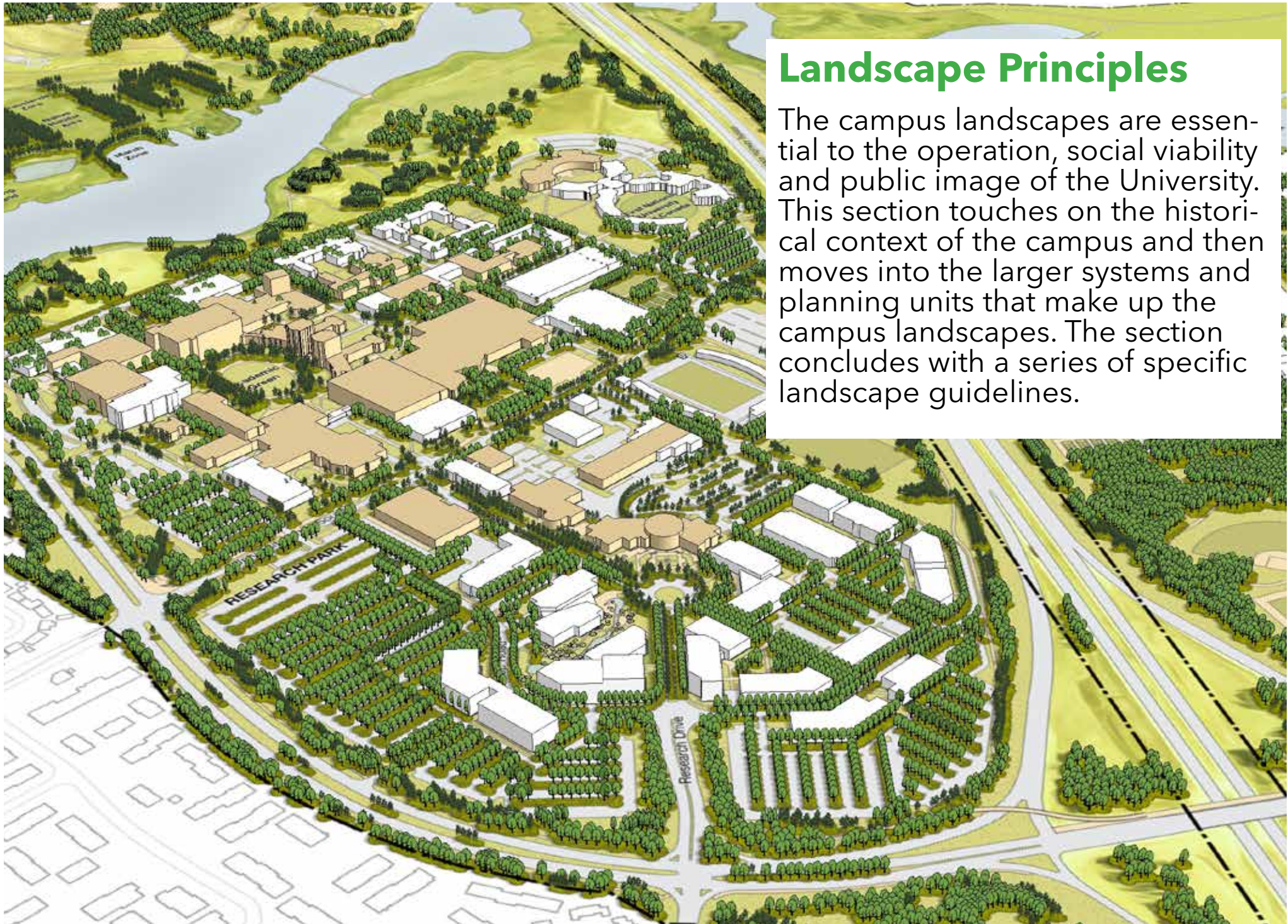

# Landscape Principles

The campus landscapes are essential to the operation, social viability and public image of the University. This section touches on the historical context of the campus and then moves into the larger systems and planning units that make up the campus landscapes. The section concludes with a series of specific landscape guidelines.





## Prairie Roots

The University of Regina is a prairie campus. The site chosen in the early '60s consisted of a wide open prairie grassland located on the south side of Wascana Lake. The well-developed landscapes that make up the campus today were, in effect, imported to the campus at considerable cost in terms of resources and human effort.

**University of Regina - Early 1970s**





University of Regina - Early 1970s

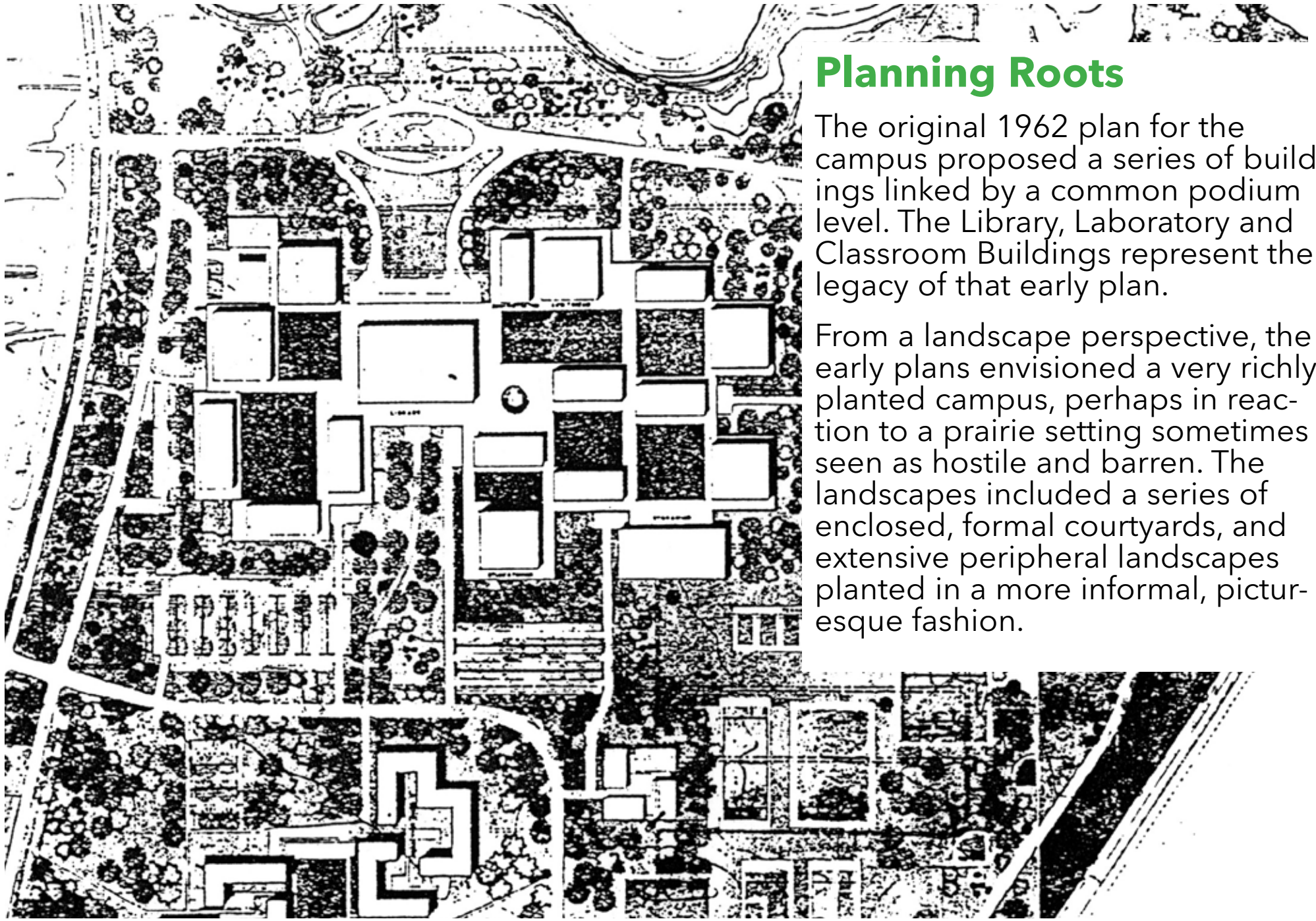

## Planning Roots

The original 1962 plan for the campus proposed a series of buildings linked by a common podium level. The Library, Laboratory and Classroom Buildings represent the legacy of that early plan.

From a landscape perspective, the early plans envisioned a very richly planted campus, perhaps in reaction to a prairie setting sometimes seen as hostile and barren. The landscapes included a series of enclosed, formal courtyards, and extensive peripheral landscapes planted in a more informal, picturesque fashion.

1962 Yamasaki + Church Plan

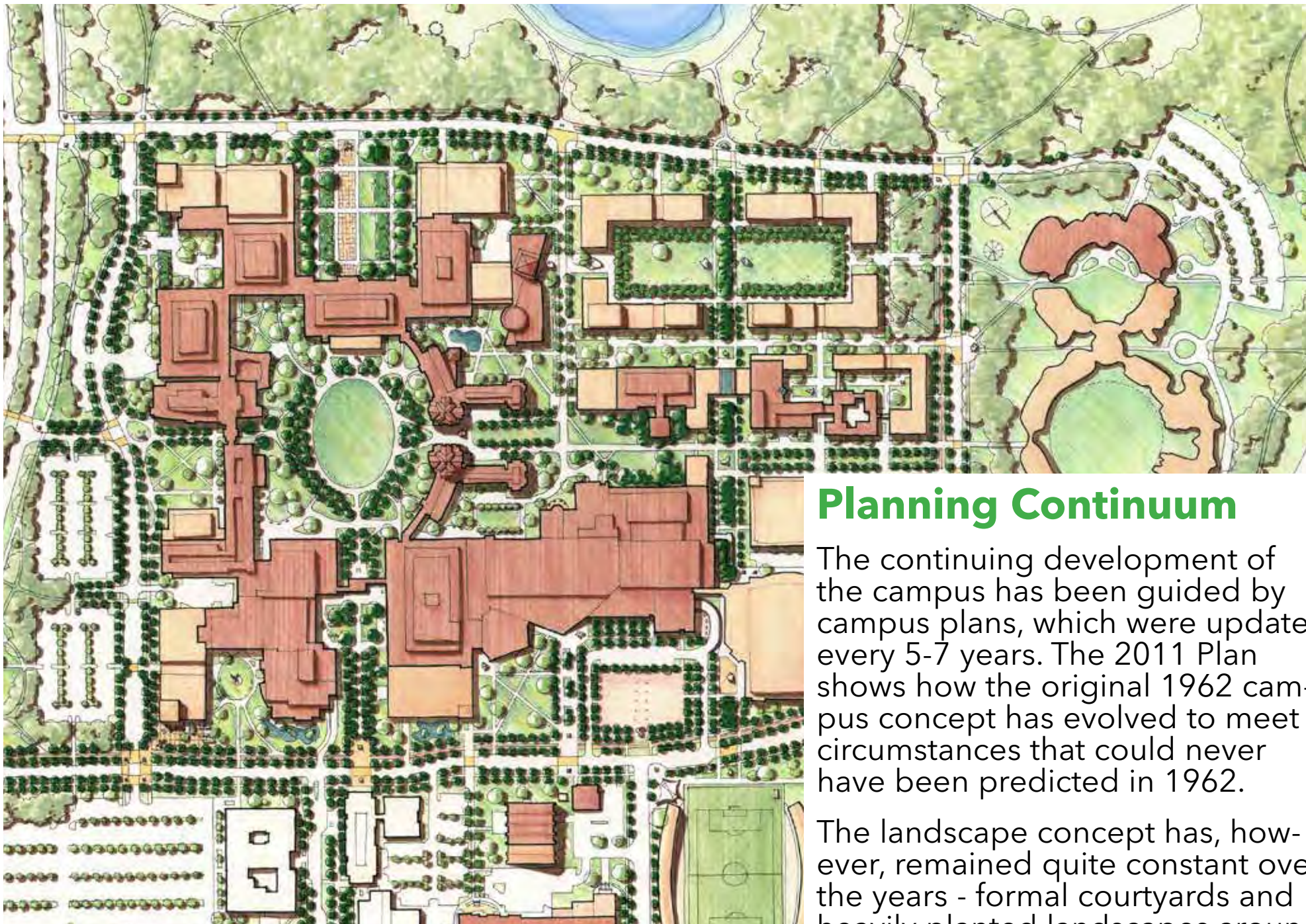

**2011 Campus Plan**

## Planning Continuum

The continuing development of the campus has been guided by campus plans, which were updated every 5-7 years. The 2011 Plan shows how the original 1962 campus concept has evolved to meet circumstances that could never have been predicted in 1962.

The landscape concept has, however, remained quite constant over the years - formal courtyards and heavily planted landscapes around the periphery of the campus.

## Campus Structure

As the campus matures, the basic systems and organizational structure of the campus should be further clarified.





## A Maturing Campus

After nearly half a century of development, large parts of the campus landscape are maturing. They are maturing not in the sense that they are “finished”, but in the sense that they have received considerable attention and now have a sense of identity. In these parts of the campus, the previous focus on development will shift to ongoing maintenance and management.



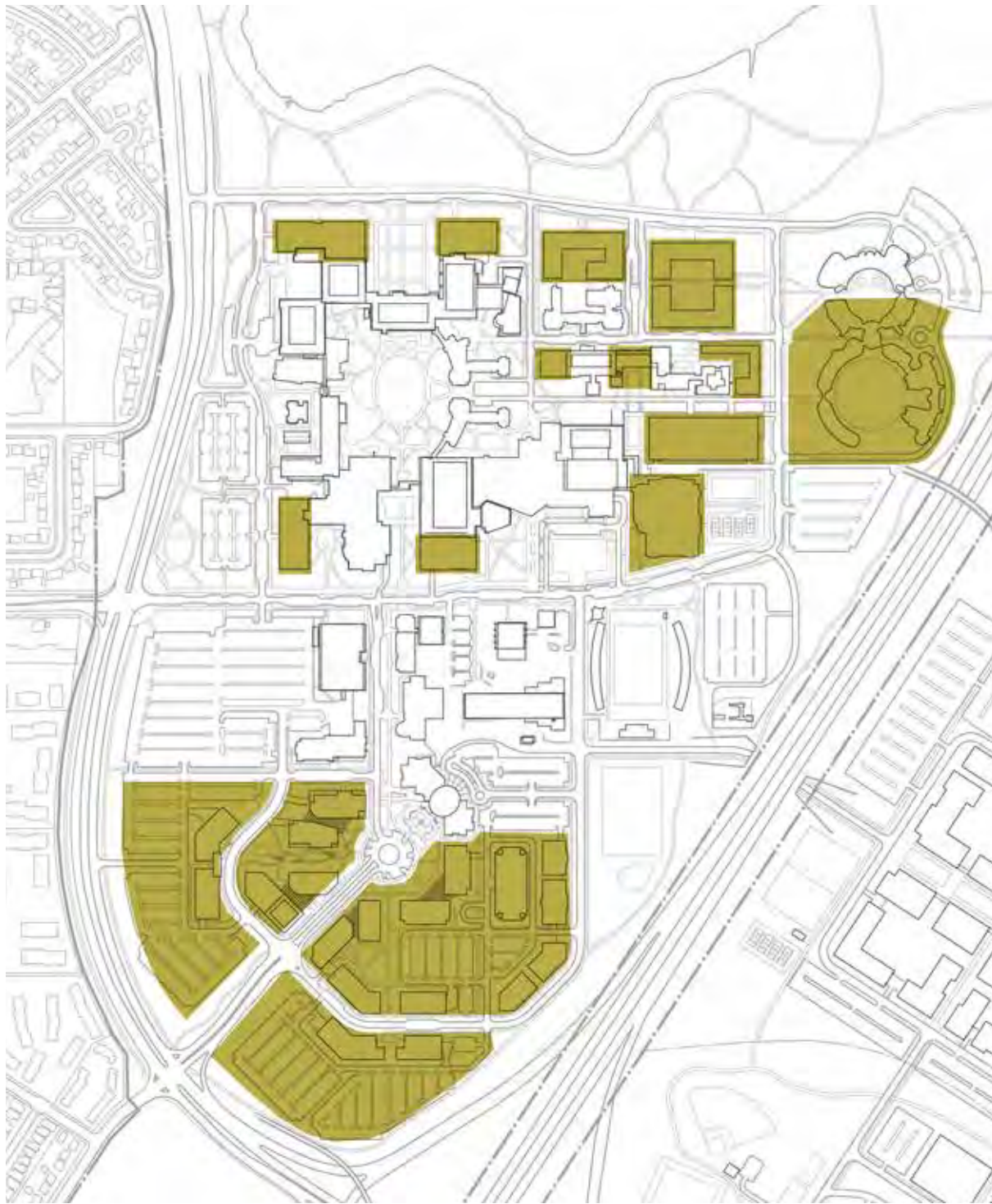

## An Evolving Campus

Notwithstanding the relative maturity of large parts of the campus, new development is contemplated in many areas. While a few important projects are identified within the campus core, most sites identified in the 2011 Plan are located around the periphery of the Campus Core, and south of Innovation Place Research Park.

**First Nations University of Canada**

**Campus Core**

**Innovation Place**

## Campus Precincts

The University of Regina consists of three major precincts. Although these precincts are physically and programmatically connected, they each have distinct purposes and distinct identities. Through ongoing landscape development, the unique character and purpose of each precinct should be expressed.



## Primary Roads

A network of primary campus roads is emerging and will be reinforced in the Plan. In addition to providing access to major destinations, the roads convey a first impression of the campus to visitors, and serve as important wayfinding devices.



## Wascana Parkway

Wascana Parkway is the first and immediate link between the campus and the City. It is a major traffic artery and the primary means of accessing the campus, and it largely defines the first impression people have of the University of Regina.





## Prairie, Marsh and Lake

The landscapes north of University Drive North include grasslands and wetlands that strongly recall the prairie roots of the University of Regina. This complex of landscapes should be recognized as an important dimension of the University's history and identity.



## Supporting Landscapes

Landscapes to the south and east of Innovation Place will continue to fulfil important parking, recreation and service functions. They are also highly visible landscapes that should be developed in ways that support and reinforce the University's public image.

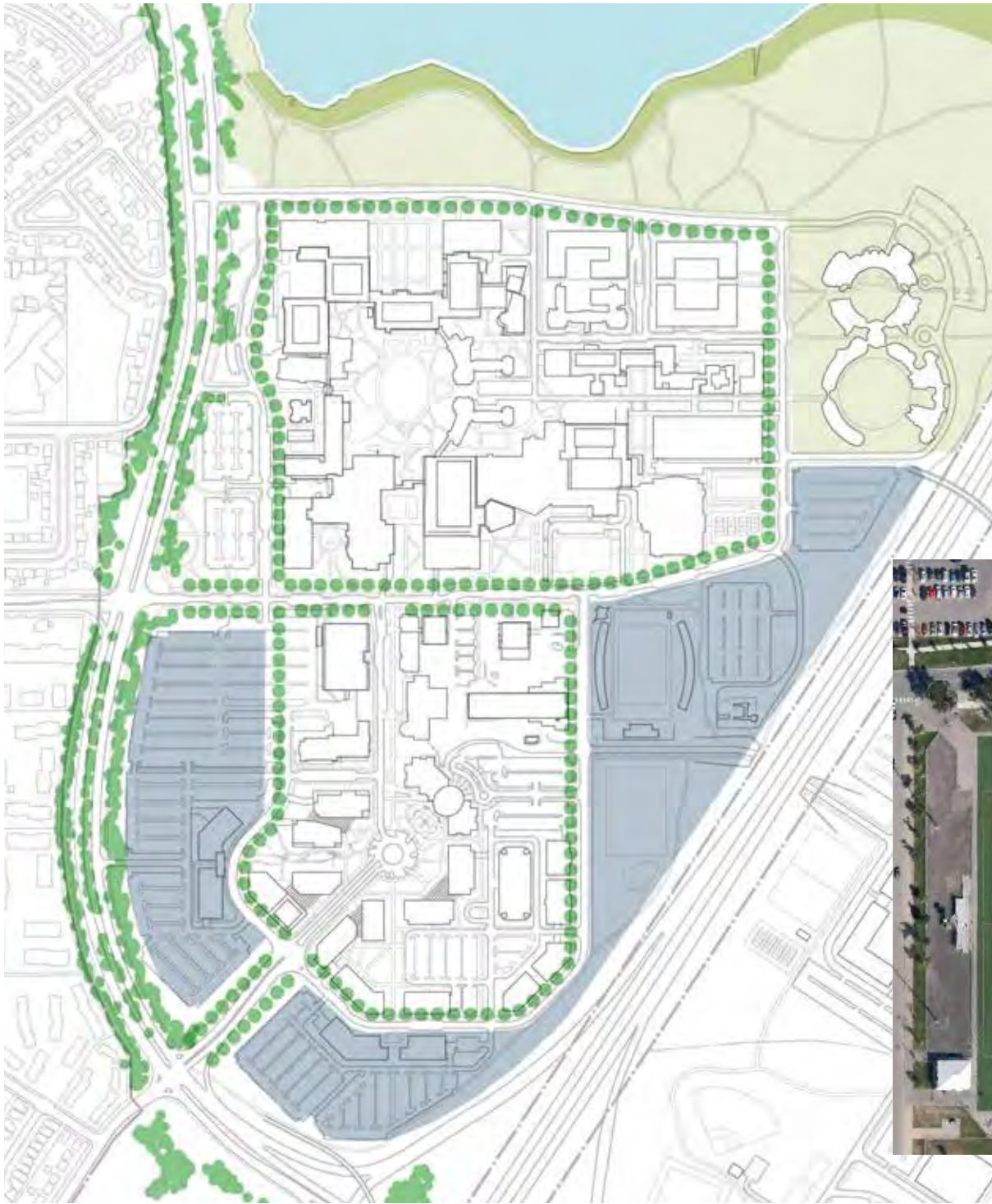

## Supporting Landscapes

## The Inner Campus

The Inner Campus consists of a series of linked landscapes that are, for the most part, identifiable and well-developed. These landscapes accommodate most out-of-doors pedestrian circulation during nice weather, and provide much-needed visual respite during the winter months when people tend to remain indoors.

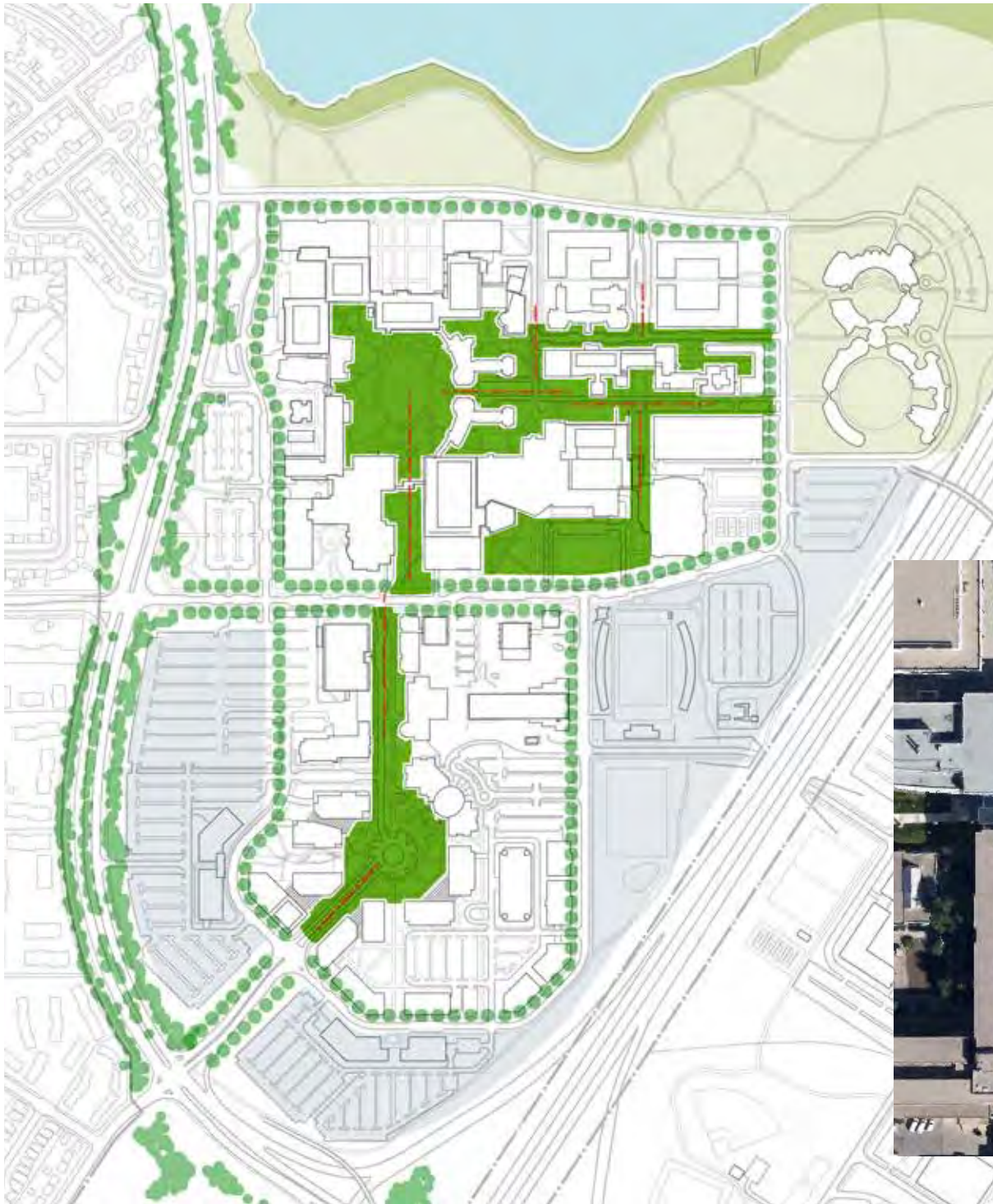

## Courtyards and Plazas

The campus also includes a number of discrete landscapes that are defined and enclosed by the buildings around them. The two at the Library and the Classroom Building date from the early days of the campus. Others are relatively new or are proposed in recent campus plans.



## Reaching Out

The 2016 Campus Plan will propose a bold move to create stronger connections to the surrounding context, in particular to the community and to Wascana Centre. The intention is to improve the public image of the campus and to strengthen the perception of the University's prairie context and character.

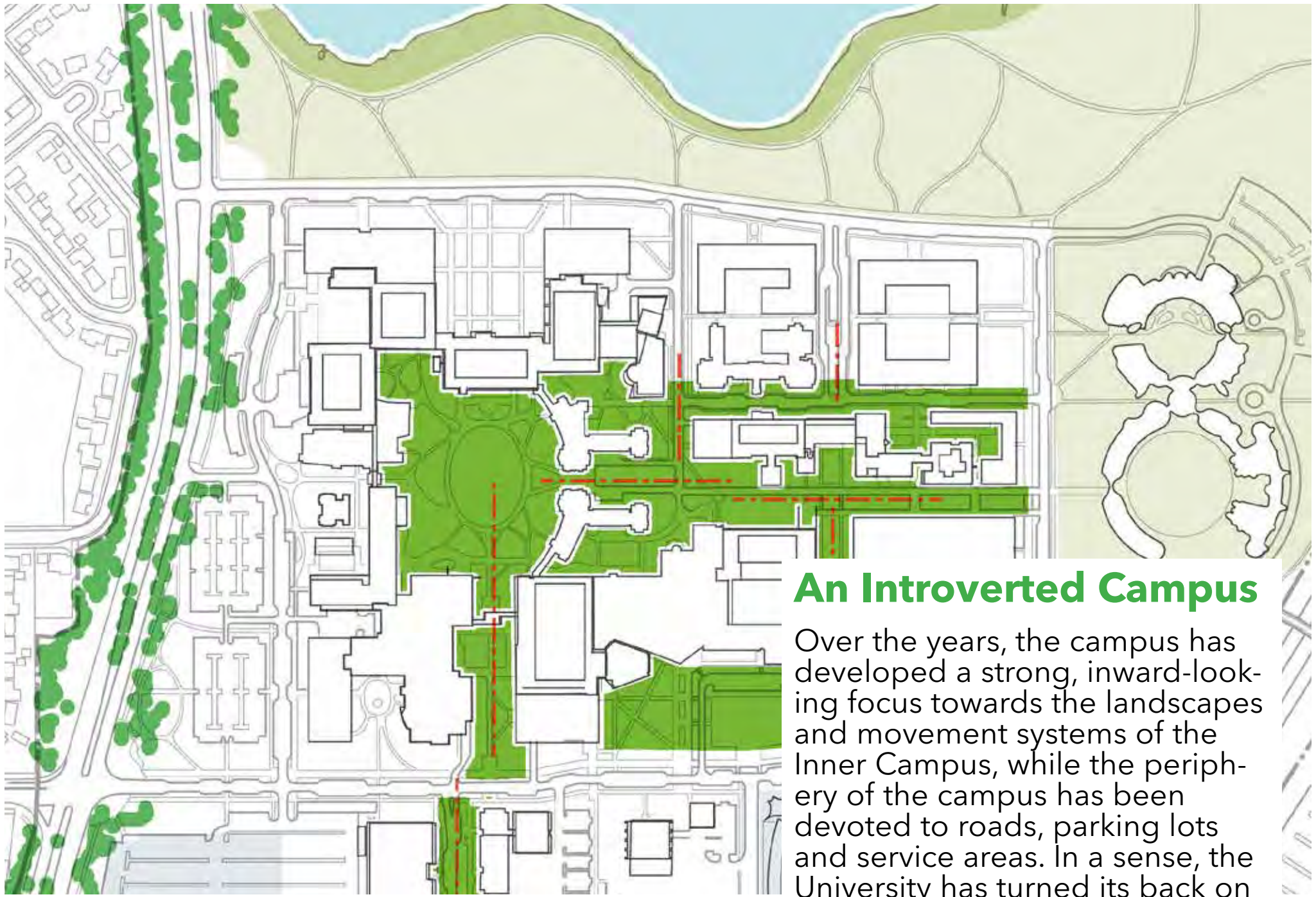

## An Introverted Campus

Over the years, the campus has developed a strong, inward-looking focus towards the landscapes and movement systems of the Inner Campus, while the periphery of the campus has been devoted to roads, parking lots and service areas. In a sense, the University has turned its back on the community and on Wascana Centre.



## The Early Days

In the first development phases, the campus was outward-looking, presenting a welcoming face to the community. At that time, the key arrival points were the forecourts to the Library and the Classroom/Laboratory Buildings.

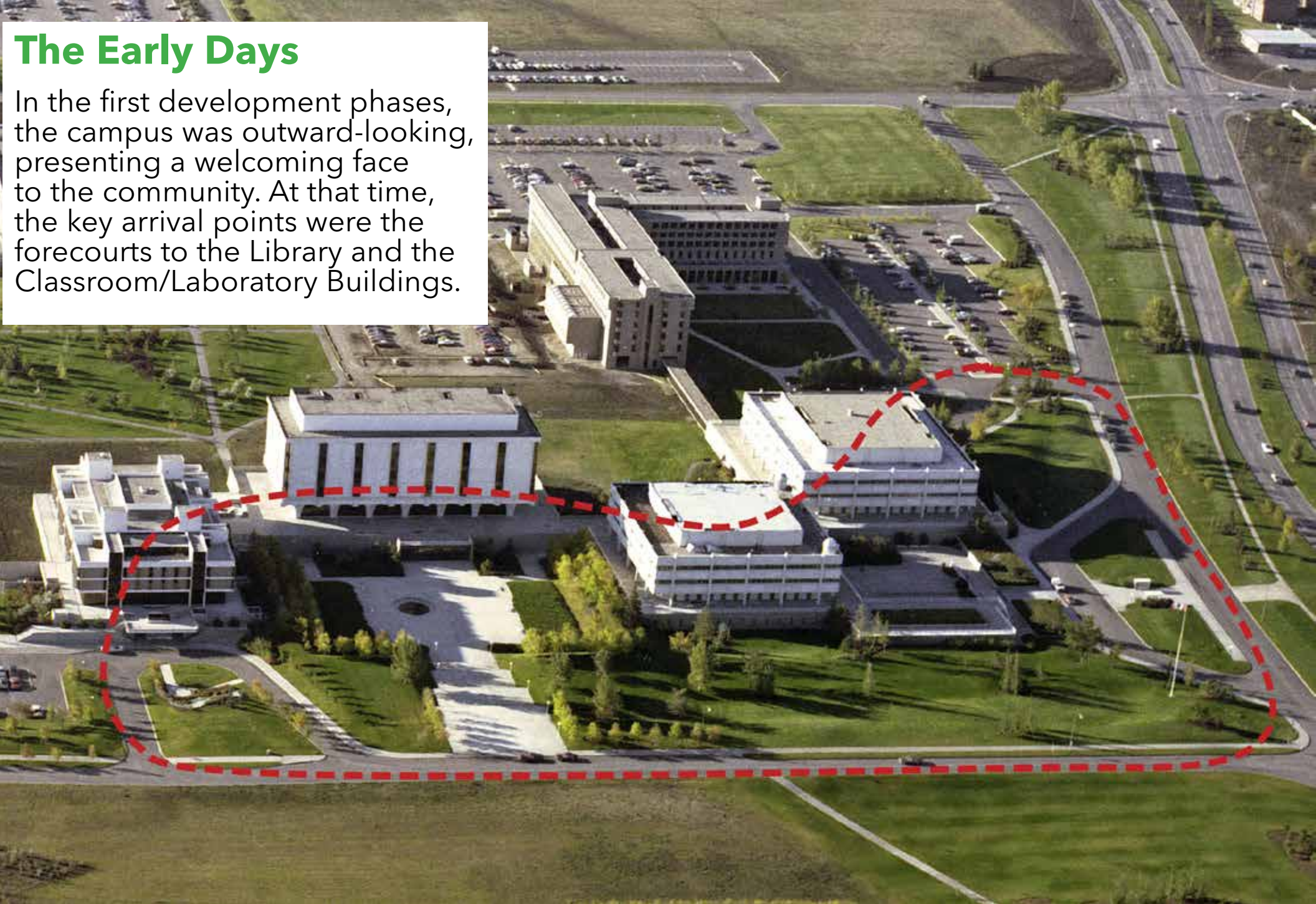

Early 1970s

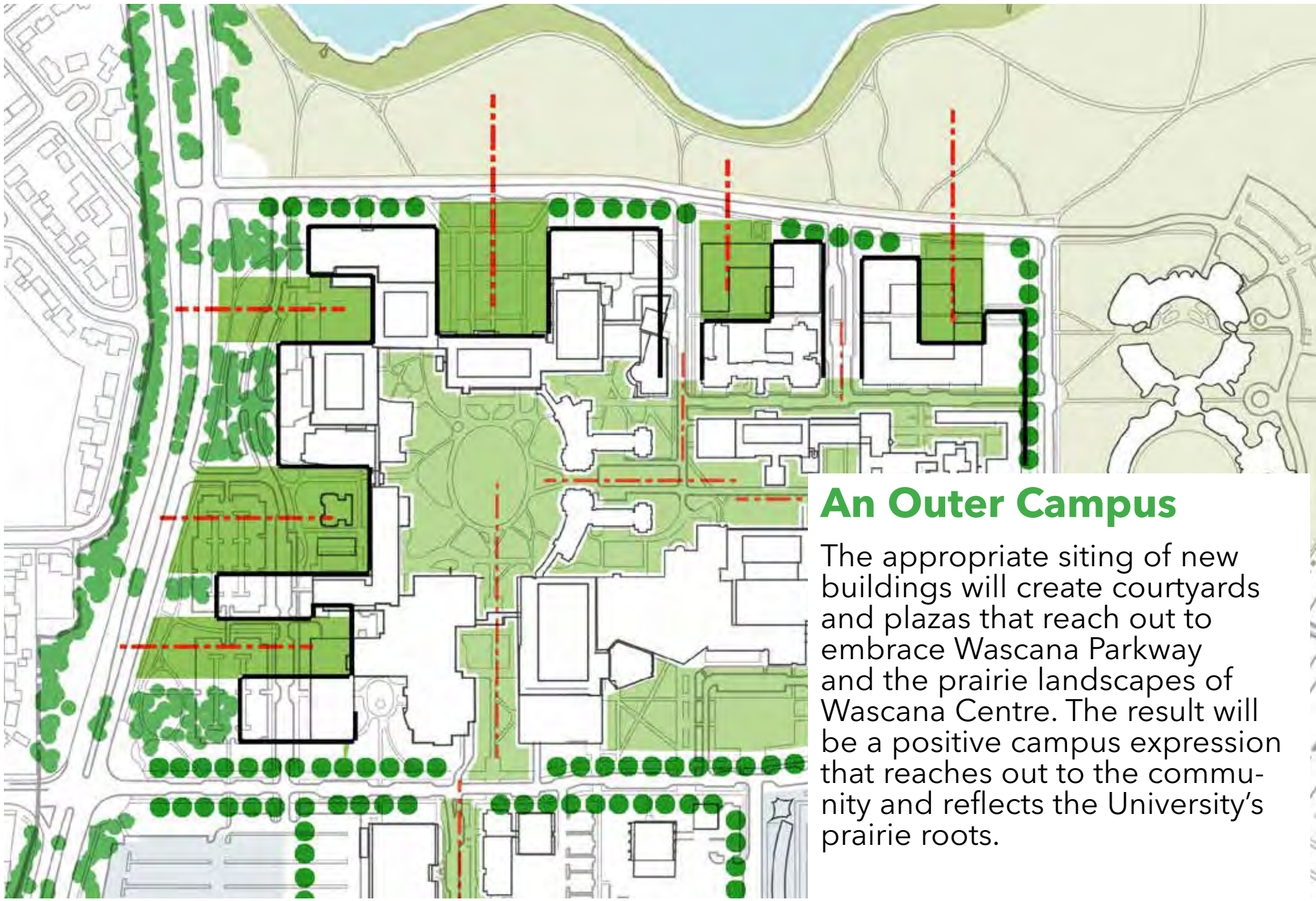

## An Outer Campus

The appropriate siting of new buildings will create courtyards and plazas that reach out to embrace Wascana Parkway and the prairie landscapes of Wascana Centre. The result will be a positive campus expression that reaches out to the community and reflects the University's prairie roots.

## Landscape Stewardship

The campus is a Prairie Place. It came from the prairie and belongs to the prairie. Future landscape development and maintenance should recognize this as a positive feature that will identify the University and make it a memorable place.

Working with, rather than against, the prairie reality will also make the campus a more sustainable place. In particular, reducing dependence on irrigation will shortly become a necessity as water sources diminish and energy costs rise.

Finally, as the work and study place for many thousands of people, the campus landscapes (and buildings) should be functional, commodious and beautiful.

The ongoing stewardship of campus landscapes should be founded on the following guidelines.

**A consistent approach to landscape design will give greater coherence to the campus.**



# Create positive landscape spaces and corridors.



# Implement a planned program of landscape repair and reinstatement.



**Establish priorities.**



**Think of the campus landscape as a research, educational and community-building resource.**





**Reduce irrigation and use it strategically.**

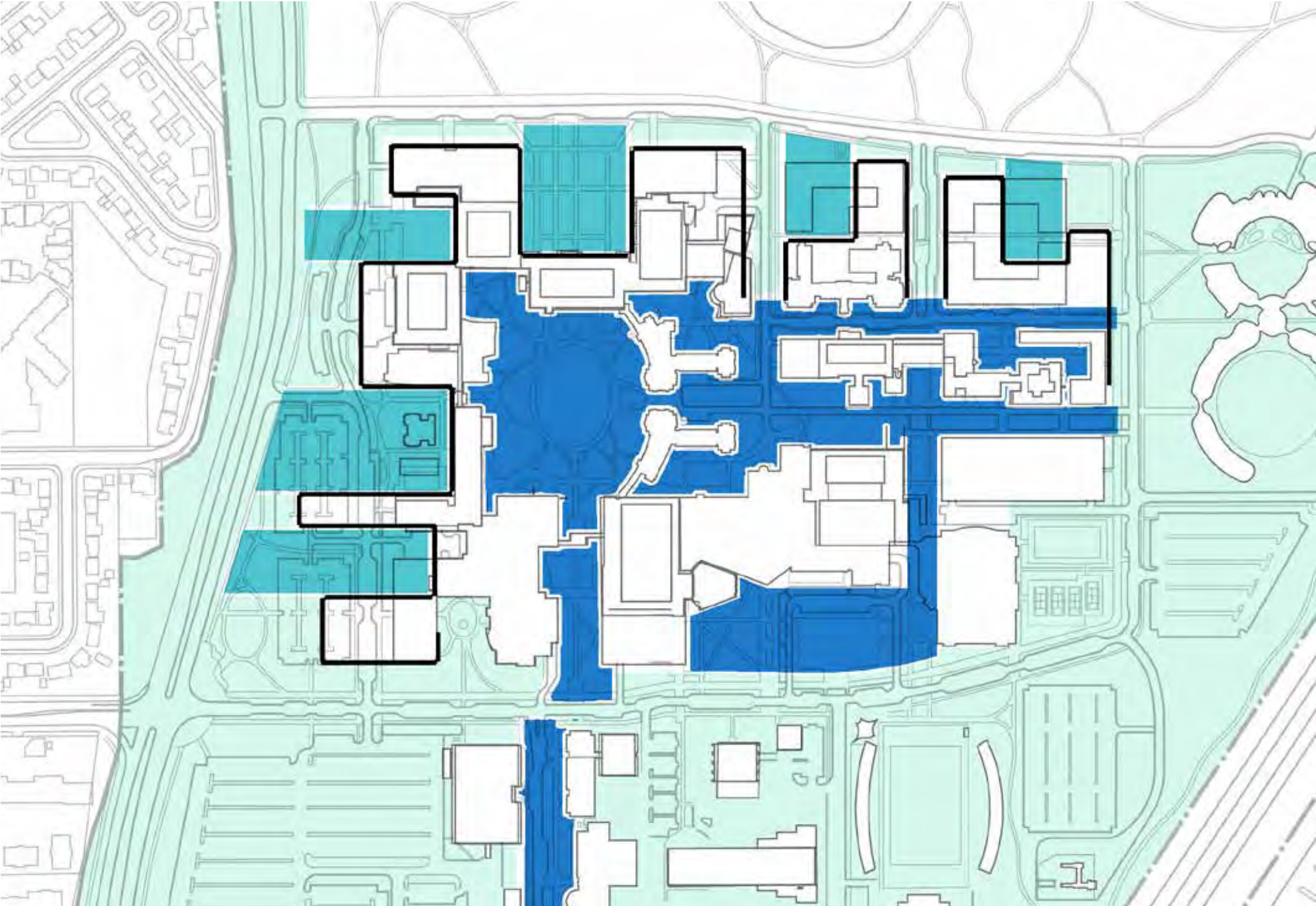

**Retain stormwater and direct it to planted areas.**



# Select deciduous trees that will reduce dependency on irrigation and reflect the local prairie context.



American Elm



Bur Oak



Green Ash



Manitoba Maple

**Use coniferous trees sparingly and primarily for wind protection.**



**Ensure a consistent supply of sustainable plant material.**



# Cultivate lands reserved for future development.



University of Regina Campus Master Plan Update >  
Phase 2 Engagement  
**Site Specific Explorations**

The following are explorations of planning/design alternatives for specific projects that have been proposed since completion of the 2011 Master Plan and the 2014 Update.



## College Avenue and Wascana Park: Existing



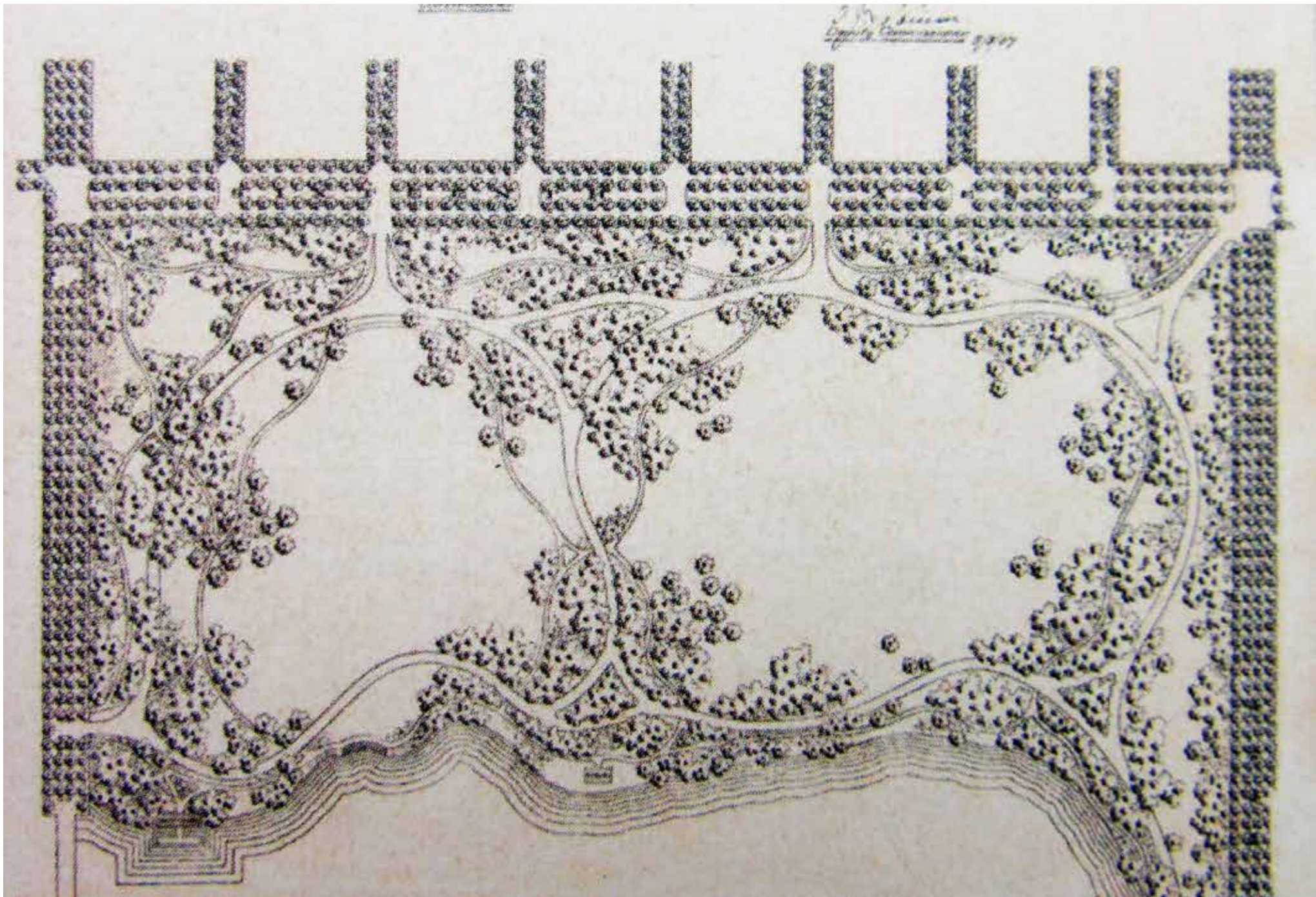

**A Romantic Landscape: Frederick Todd, 1907**

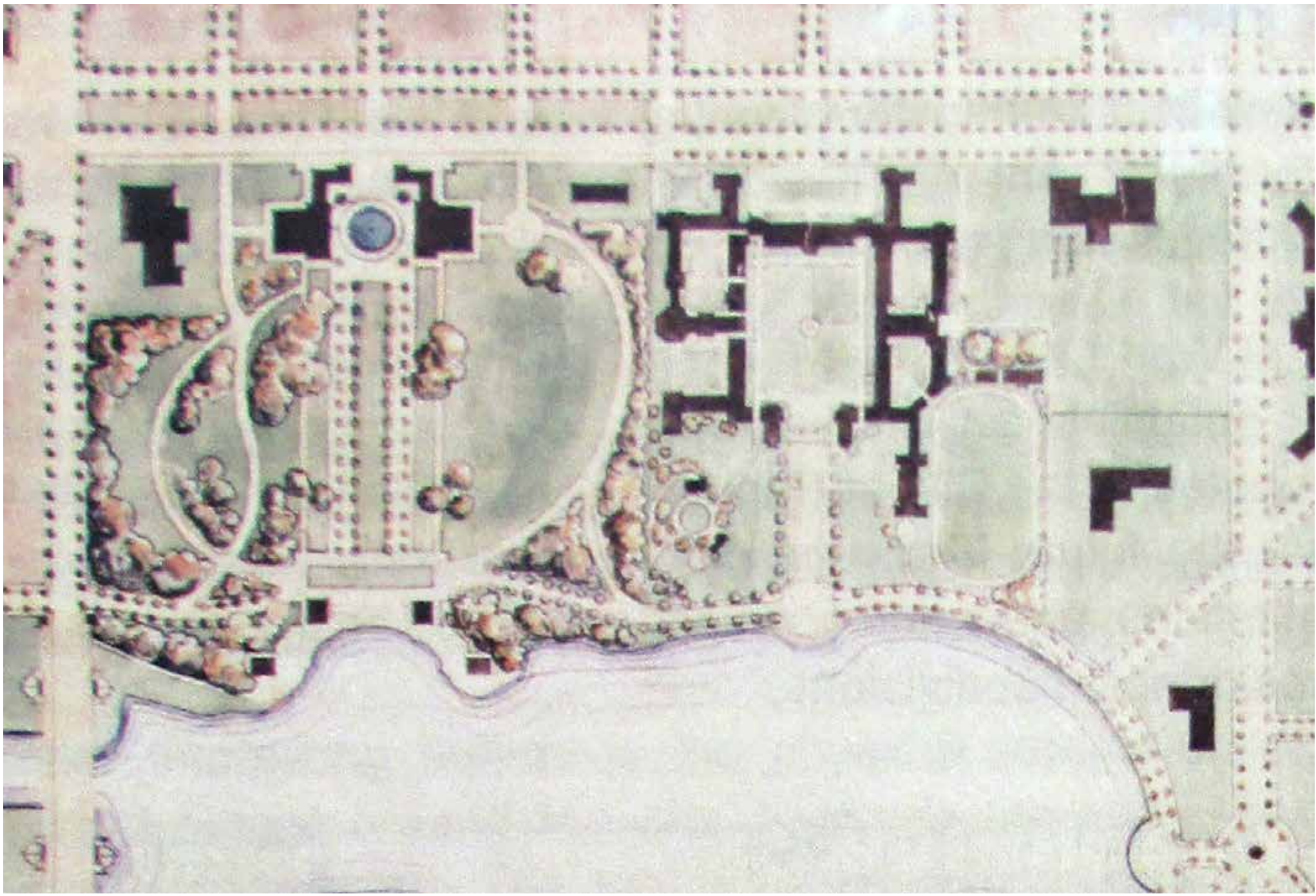

**A Romantic Landscape: Thomas Mawson, 1913**

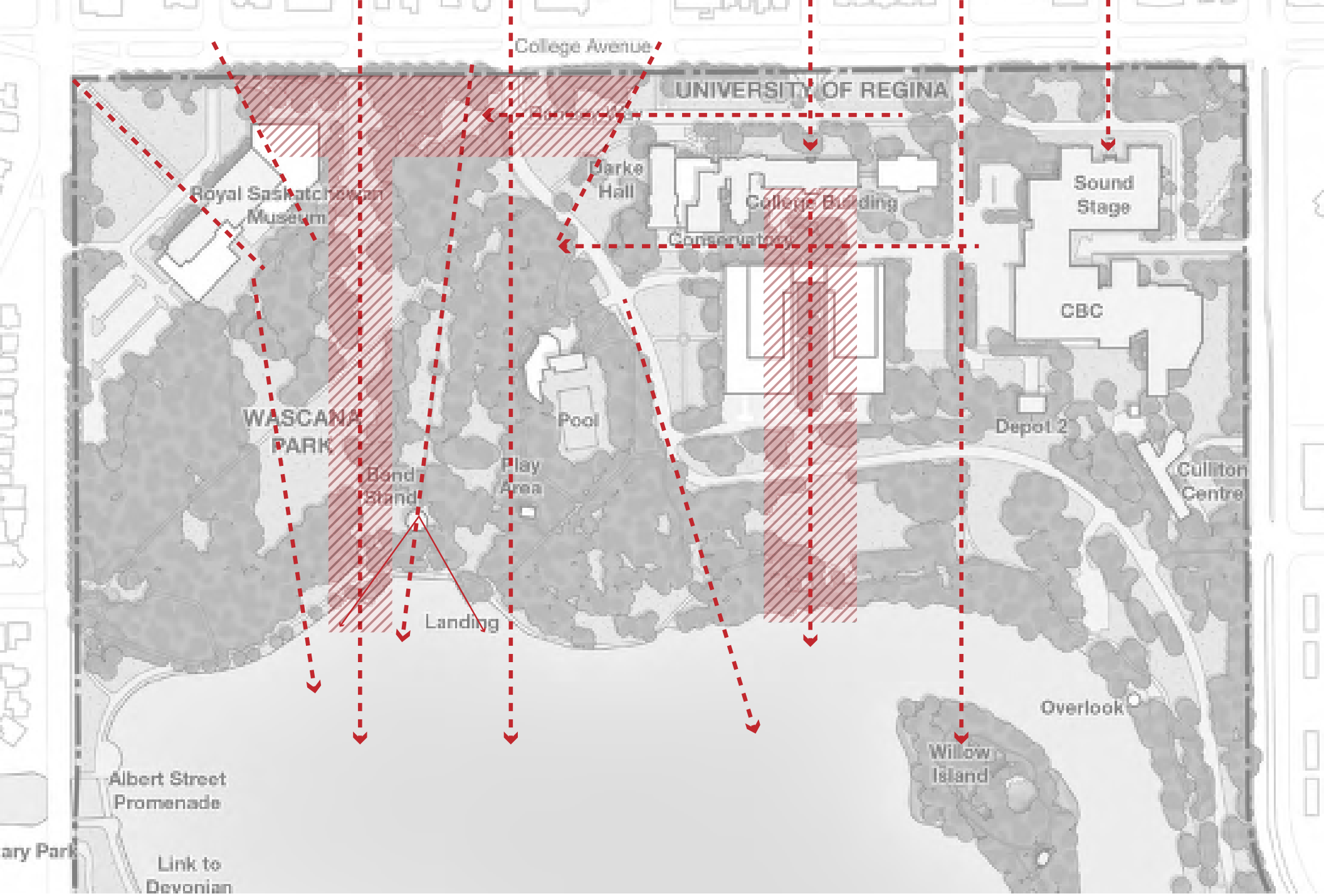

## Important Views



The original plans intended long, framed views through the landscape to important landmarks.

## View towards the Legislative Building



Elsewhere, the open landscape provides framed views of important buildings.

## Darke Hall



In some areas, the now overgrown understory should be selectively thinned to reveal these important views and improve public safety.

# View?



## 2006 Plan

The 2006 Plan proposed Museum expansion into the Park and towards College Avenue. Campus expansion included minor infil buildings along the College Ave. frontage.

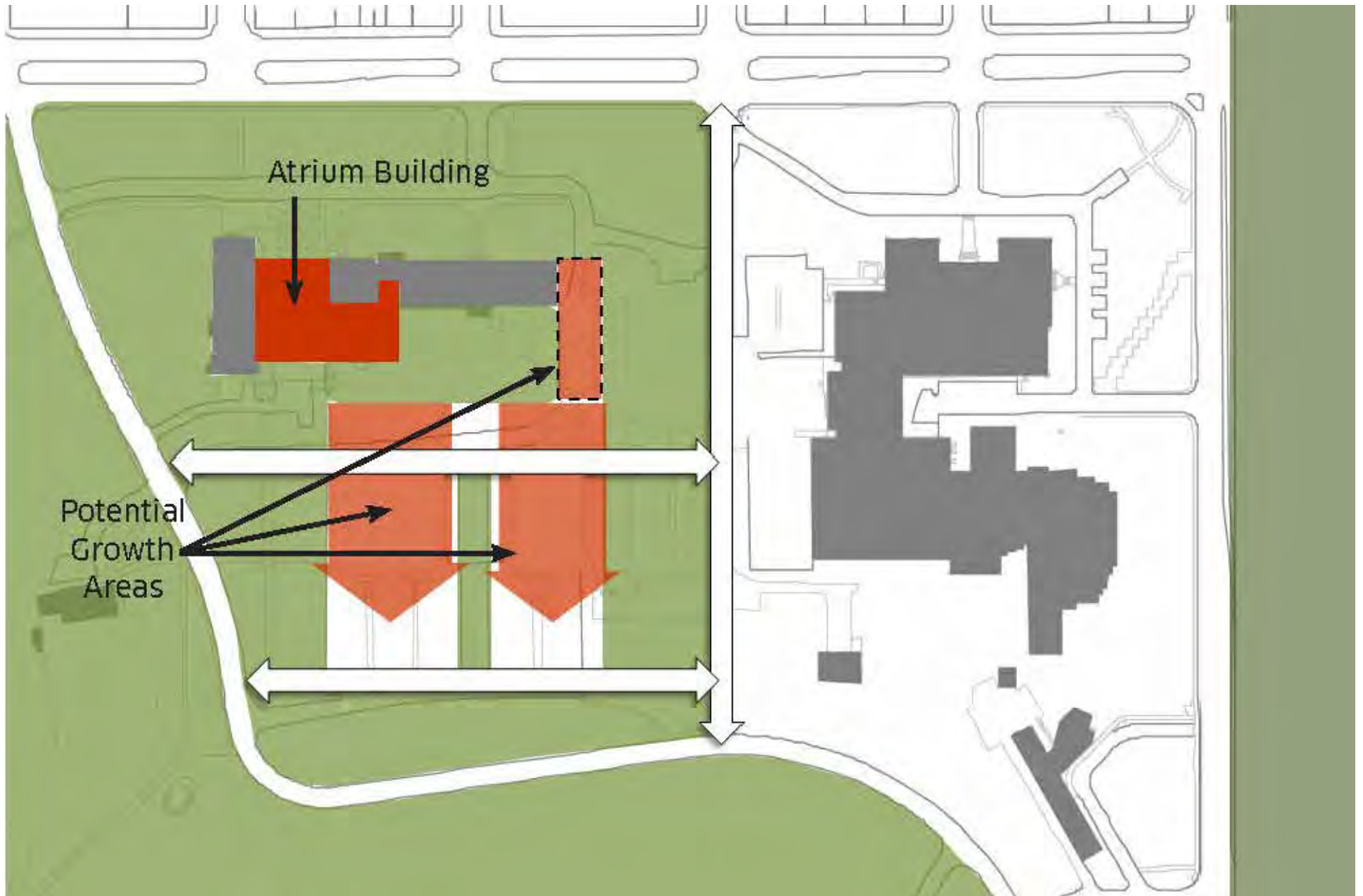

## College Avenue Campus Expansion: 2011 Campus Plan





## 2011: College Avenue and Wascana Park

## 2015 Exploration

Reinforce views into and through Wascana Park towards the Legislative Grounds.

Reconfigure future potential Museum expansion to protect one of several view “windows” into Wascana Park.

Future potential buildings on the College Avenue campus are organized to frame a central formal open space towards the lake (as per Mawson, 1913).

Protect views of heritage buildings.

Maintain building setback along College Ave.

Maintain public surface parking.

Wascana Drive realigned to rationalize the College Ave. intersection.

No new development west of Wascana Drive.

## College Avenue and Wascana Park: 2015 Exploration



## College Avenue and Wascana Park: 2015 Exploration



## Models: 2006 Plan vs 2015 Exploration

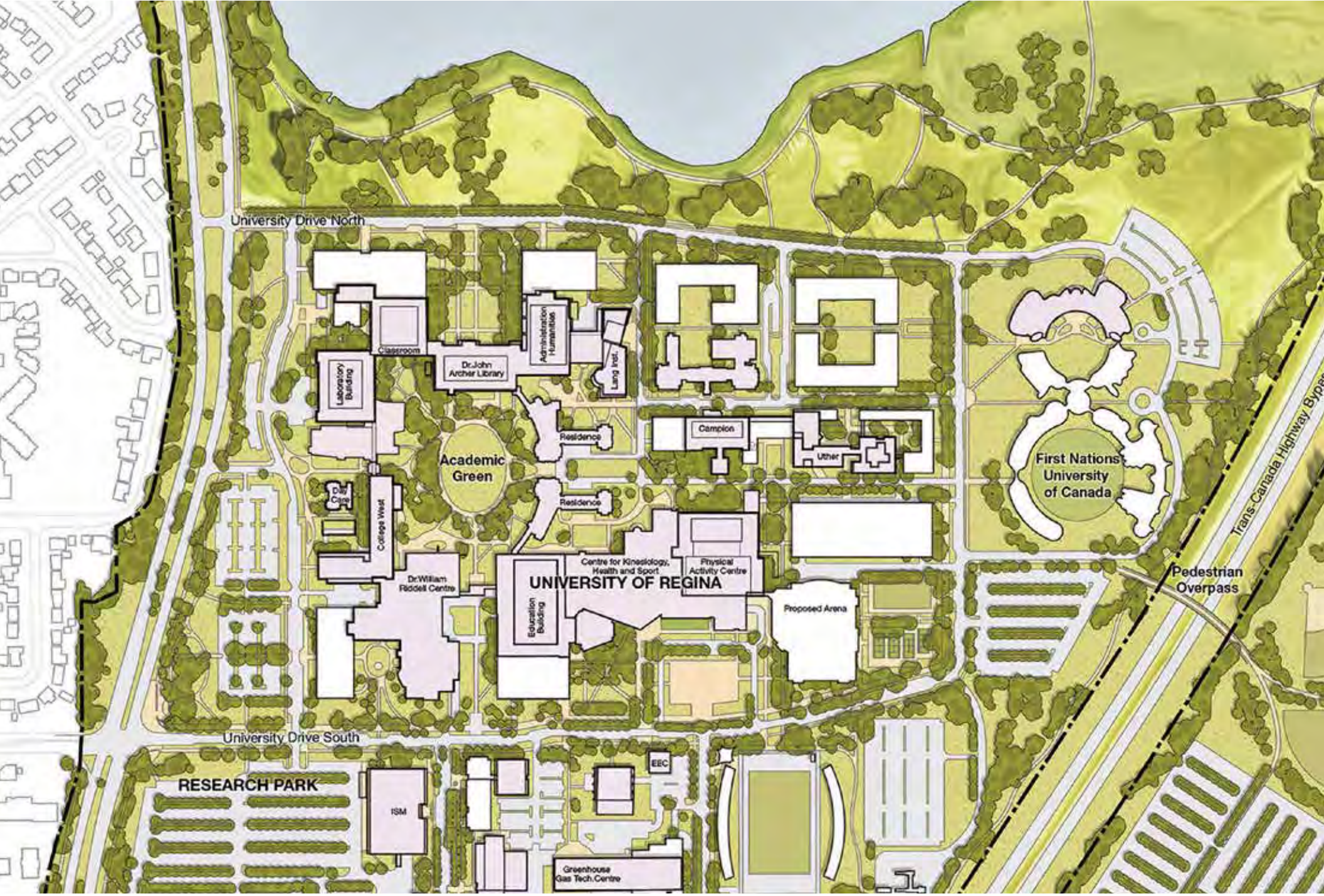

# University of Regina: 2014 Campus Plan Update

## Wascana Parkway

The original plans for the campus proposed an outward-looking campus that reached out to the community and welcomed visitors with open arms. The 1966 photo below shows this clearly.

Over the years, however, the campus has developed an inward-looking orientation with the Academic Green as its focus. Parking lots and loading docks are located around the periphery of the campus.



## Wascana Parkway Frontage: 2014 Update

## Opportunity

Through the appropriate locations of new buildings together with complementary landscape development, a series of new courtyards and plazas could be developed on the periphery of the campus. These courtyards would reach out to the community (via Wascana Parkway) and to lake and landscapes of Wascana Centre.

The courtyard landscapes would reach out to Wascana Parkway and the lake to create a fully integrated Parkway/Lake/Campus composition.

Three variations dealing primarily with circulation are presented below.

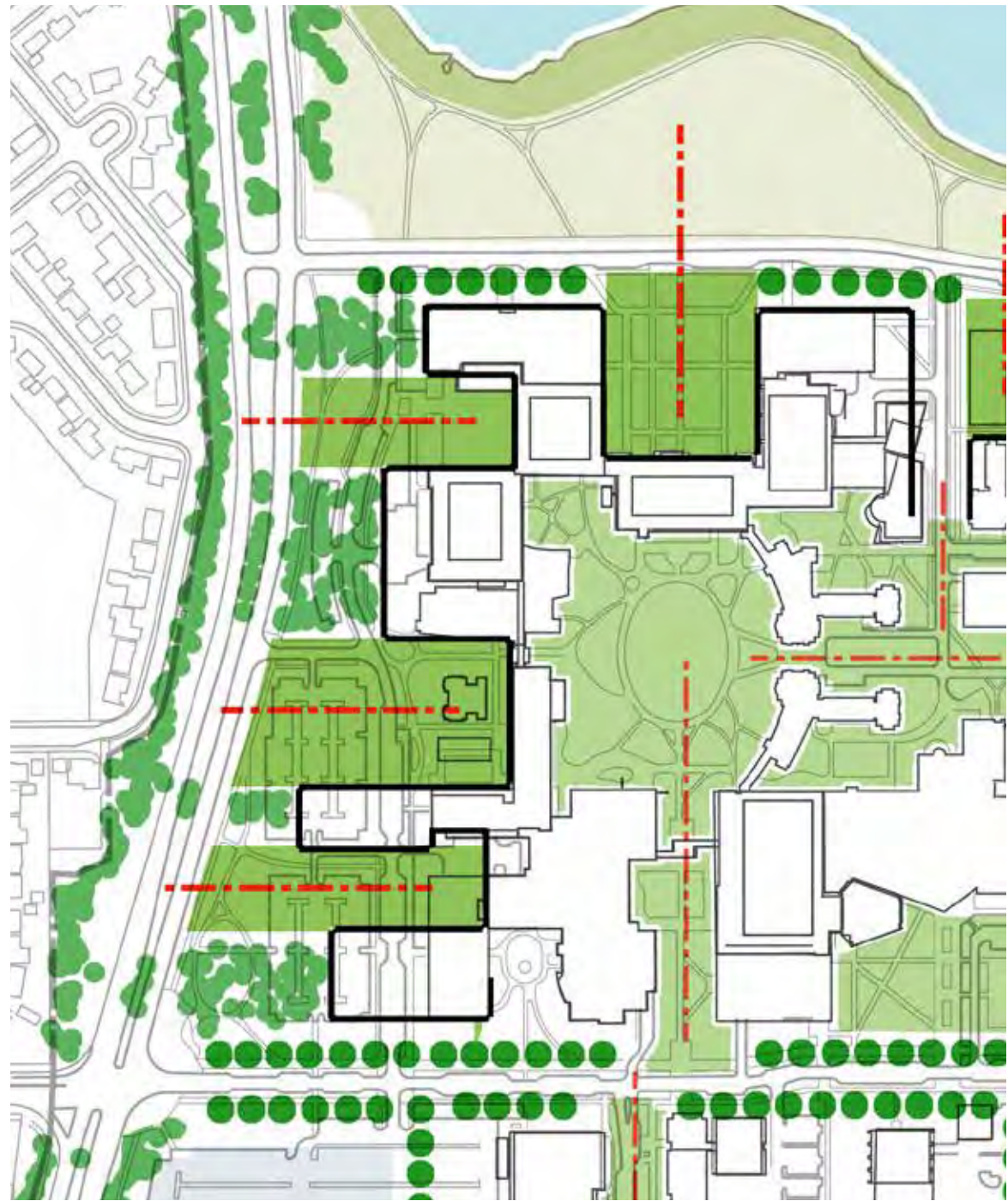

## Wascana Parkway Frontage: An Opportunity

## Exploration 1

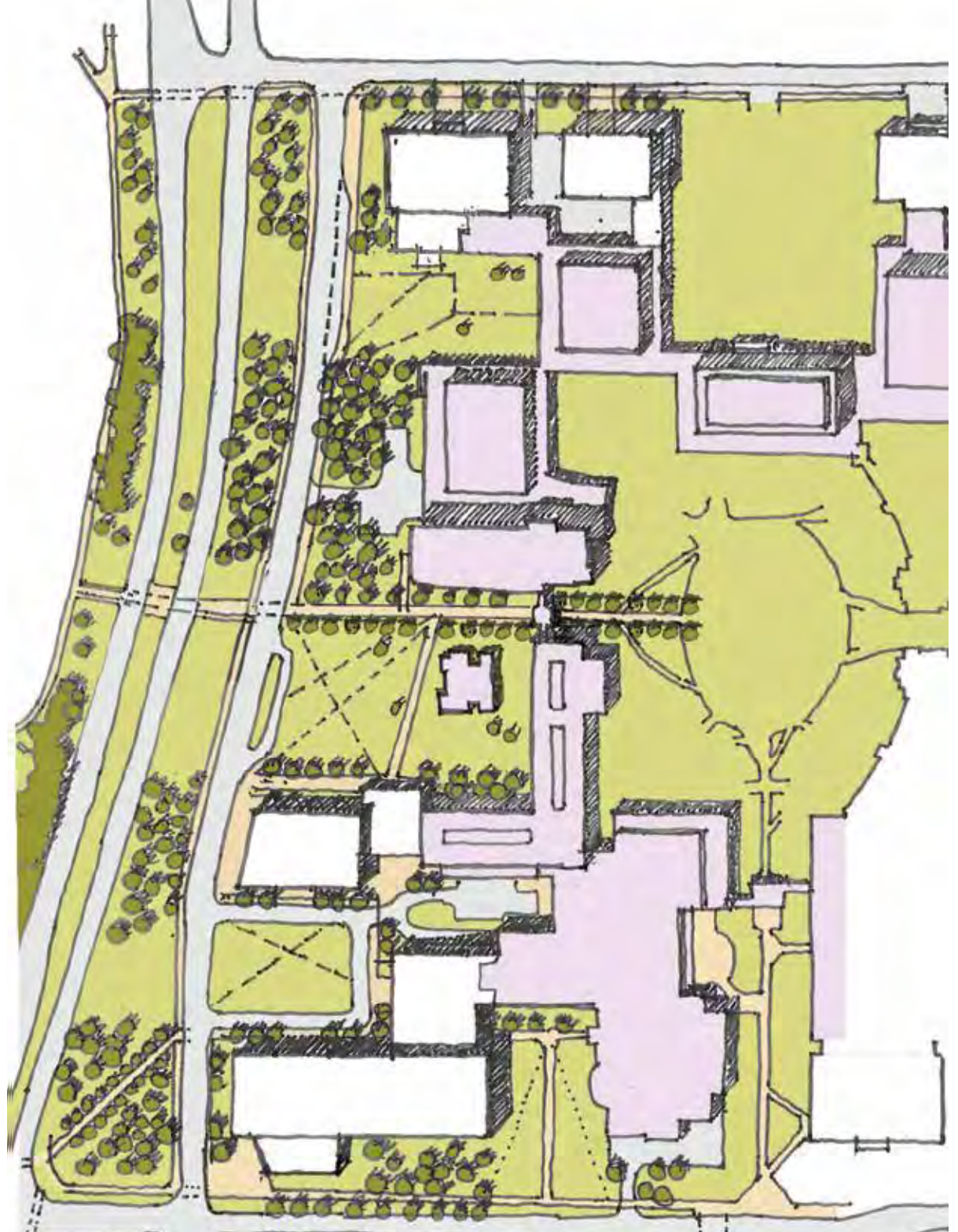



## Exploration 2

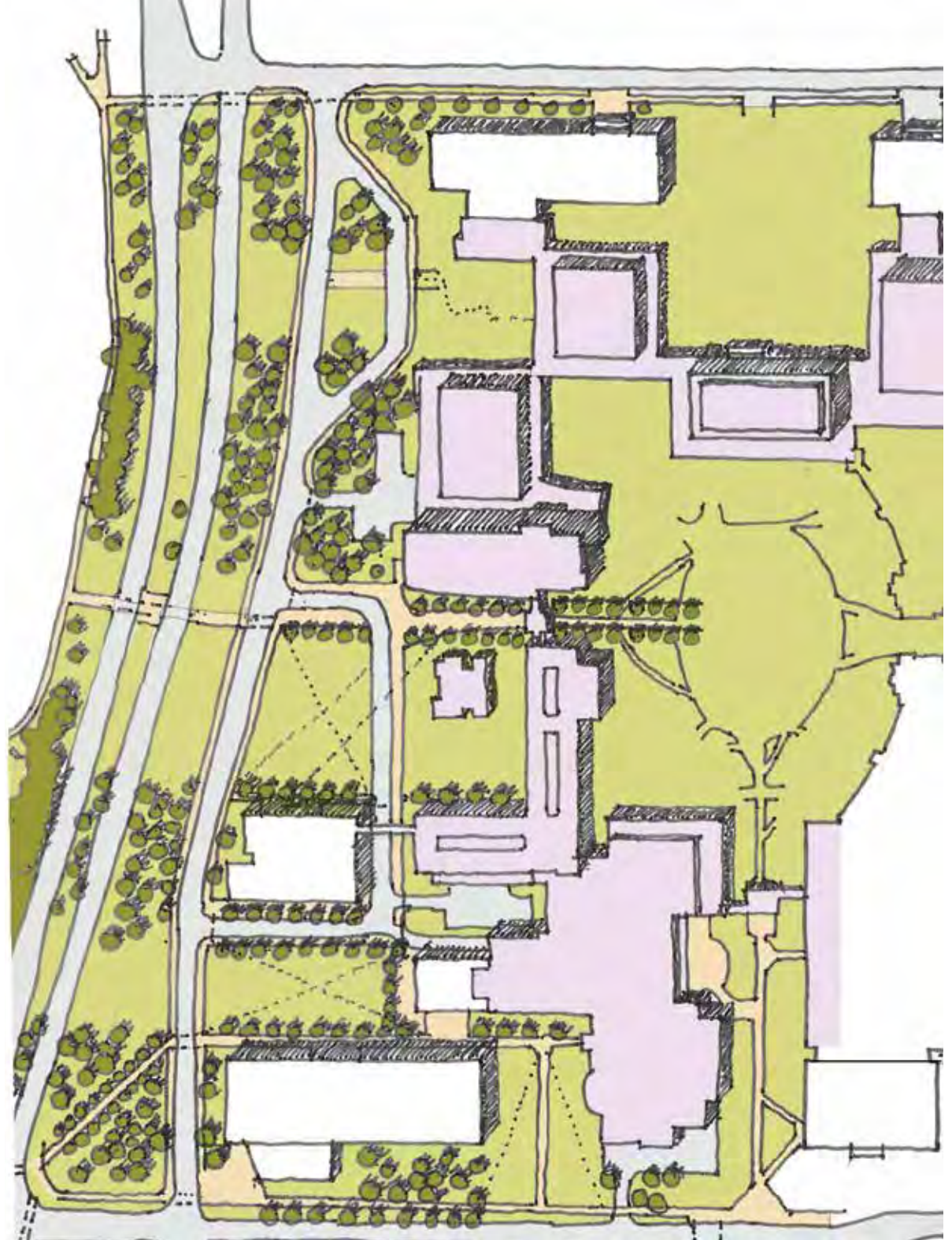

## Exploration 3

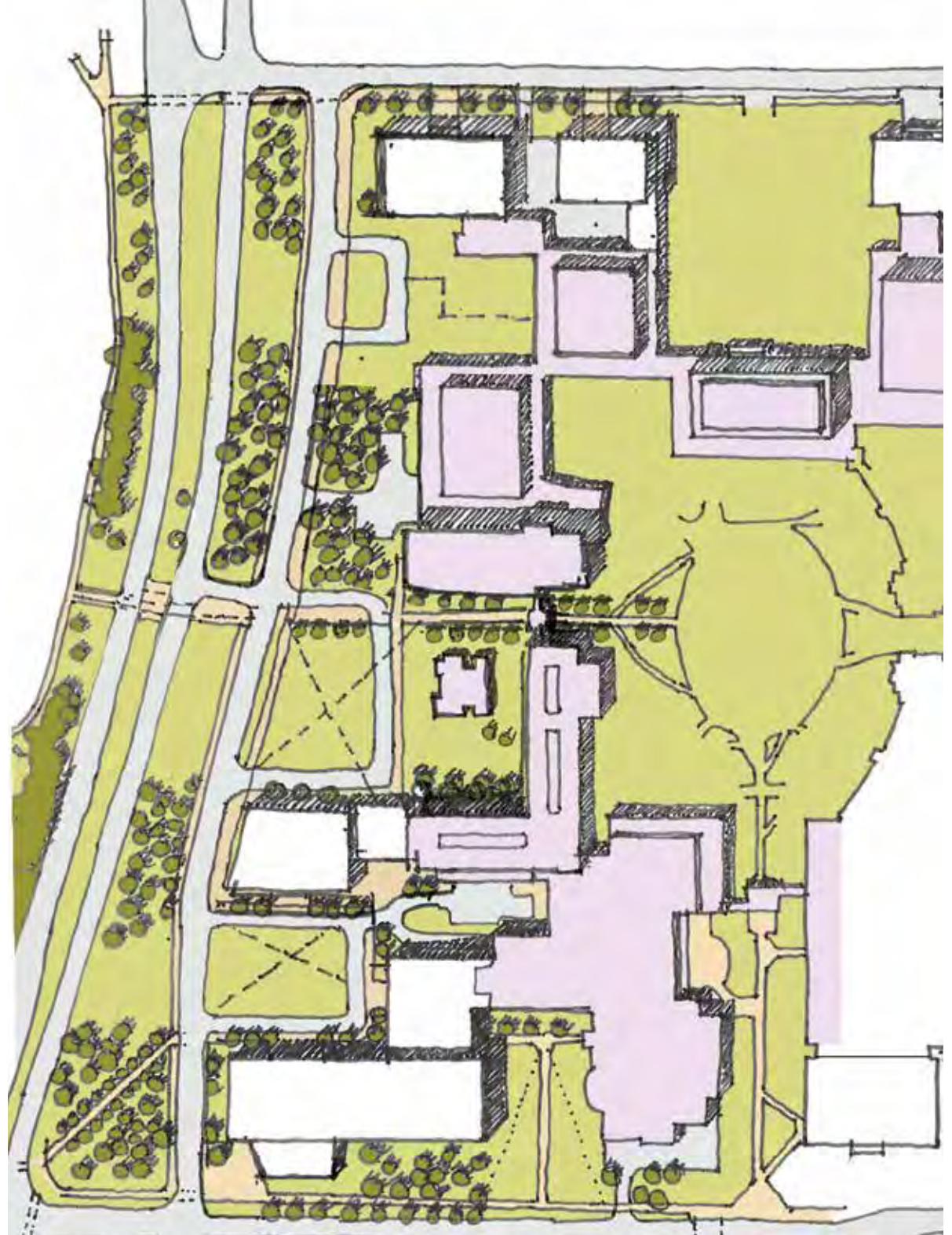

## U of R Food Services

The University is exploring options for the location and design of a central food services / dining hall to serve a rapidly increasing resident population.

A likely location exists in the vicinity of Luther and Champion Colleges. This location is close to the “centre of gravity” of the resident population. This location also presents opportunities to create indoor links between the new residences, the Colleges and the Centre for Kinesiology.

Challenges include locating sizeable service yards for the new facility and preserving the important landscapes that currently exist between the Colleges and Kinesiology.

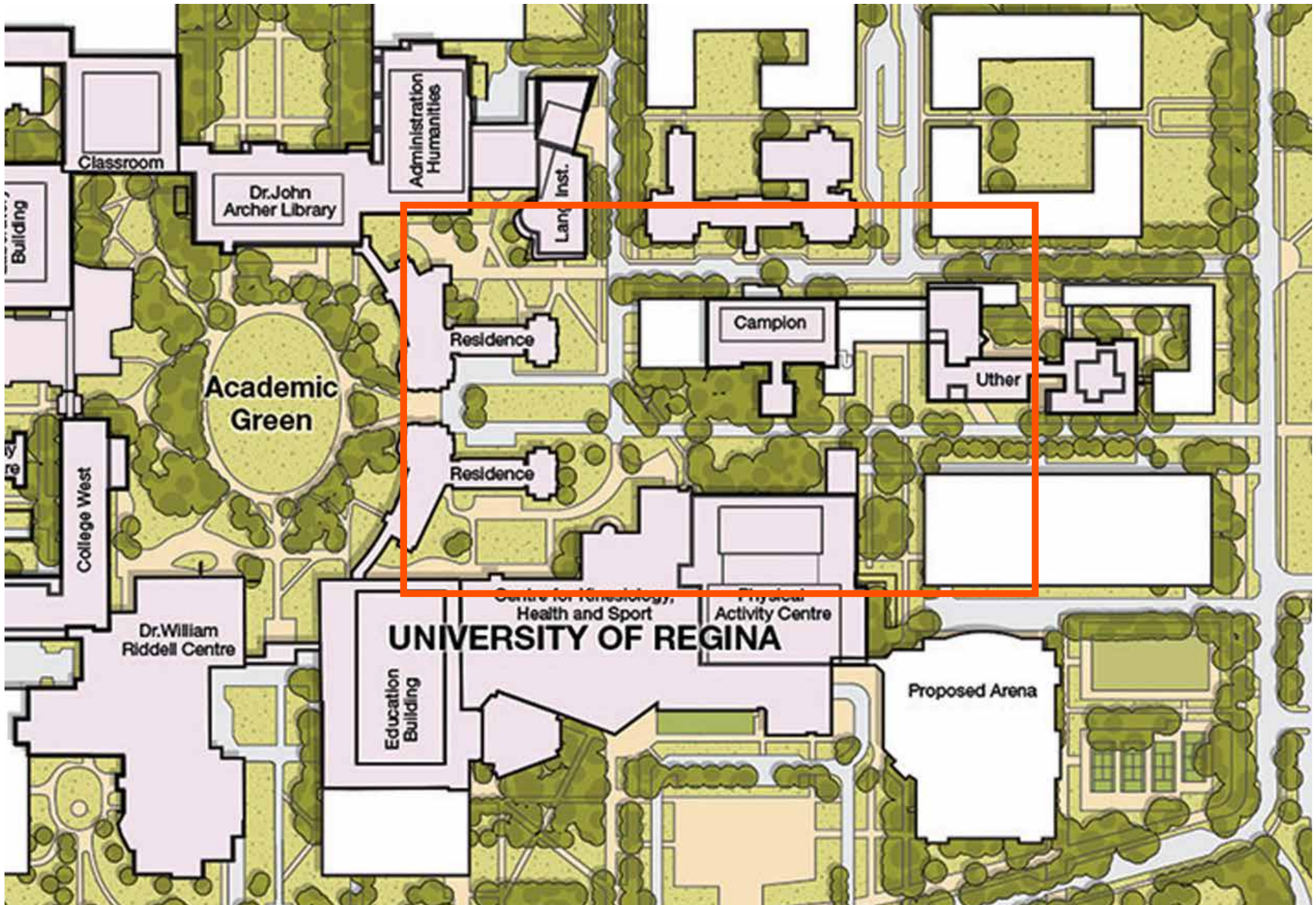

## U of R Food Services: 2014 Update

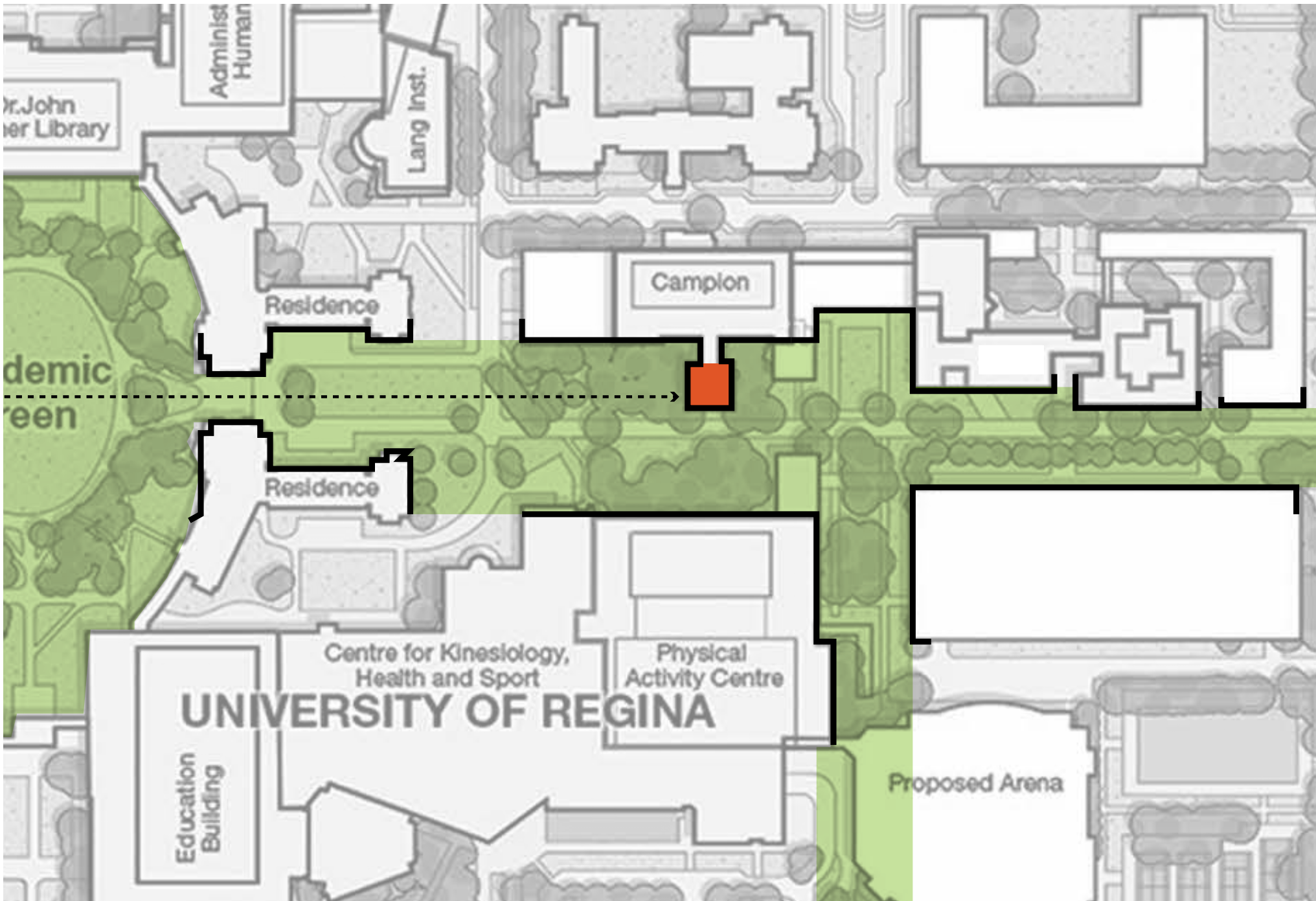

**East/West Green Corridor - Campion Chapel On-axis**

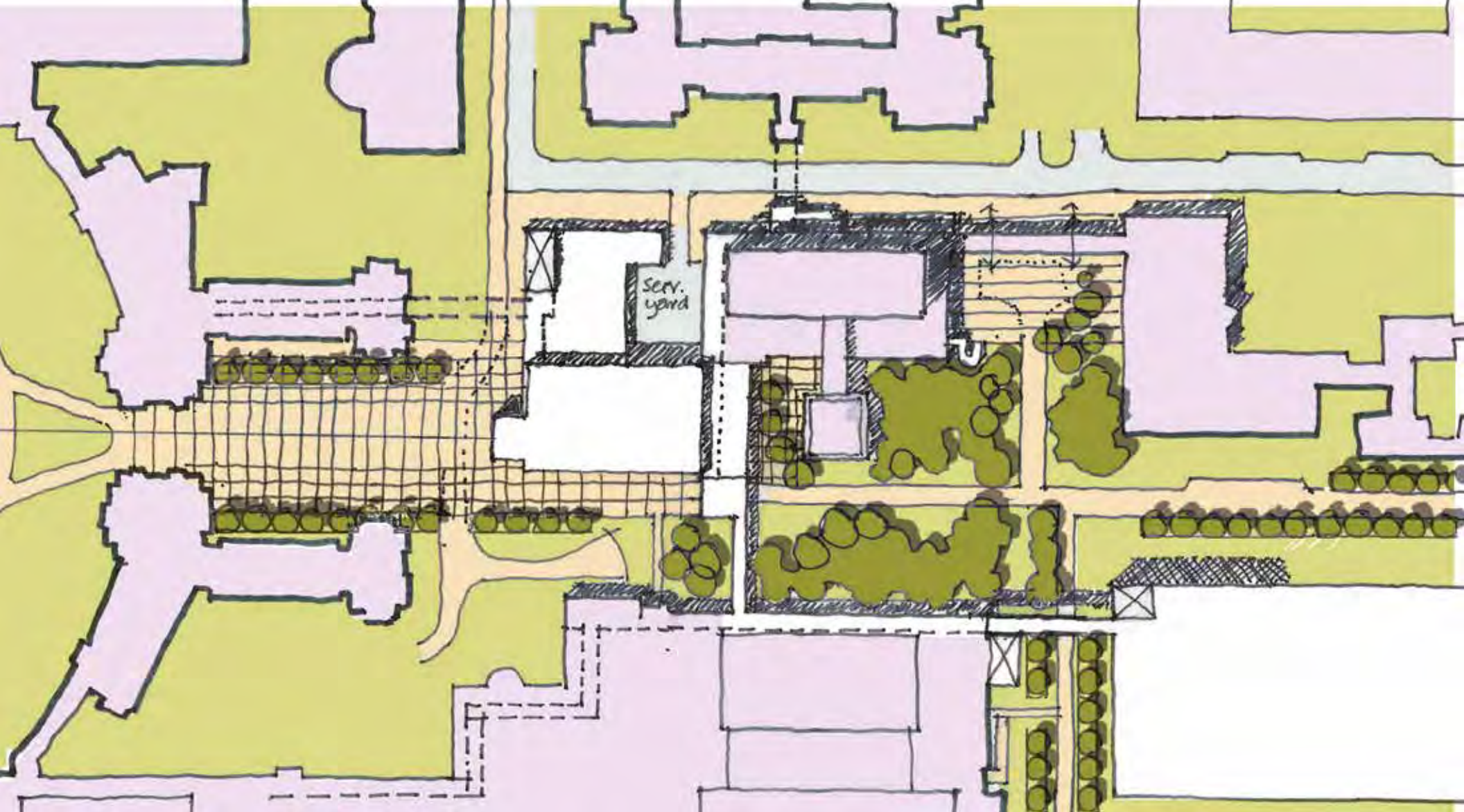

## Exploration: Dining Hall Exploration 1

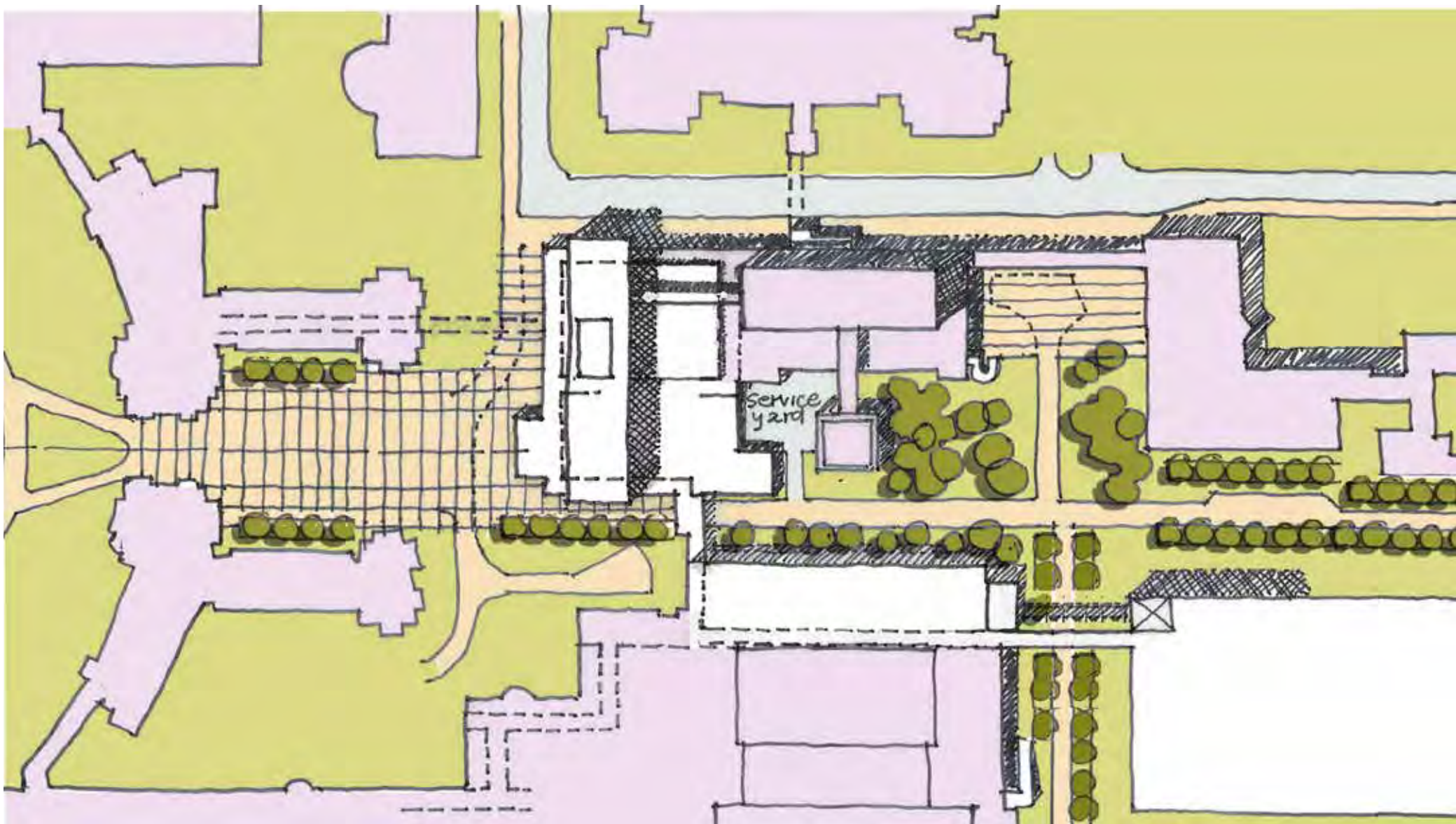

## Exploration: Dining Hall Exploration 2

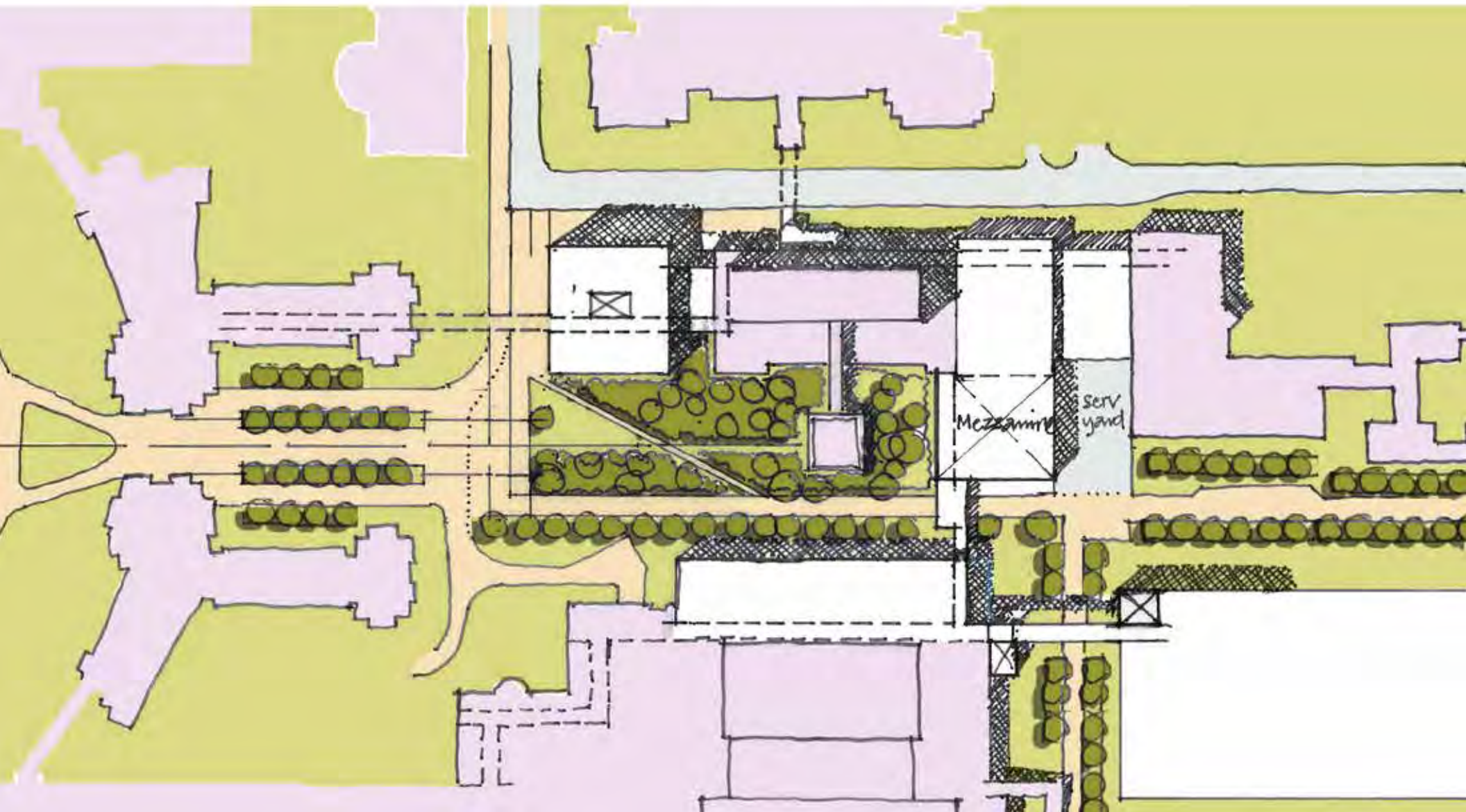

## Exploration: Dining Hall Exploration 3



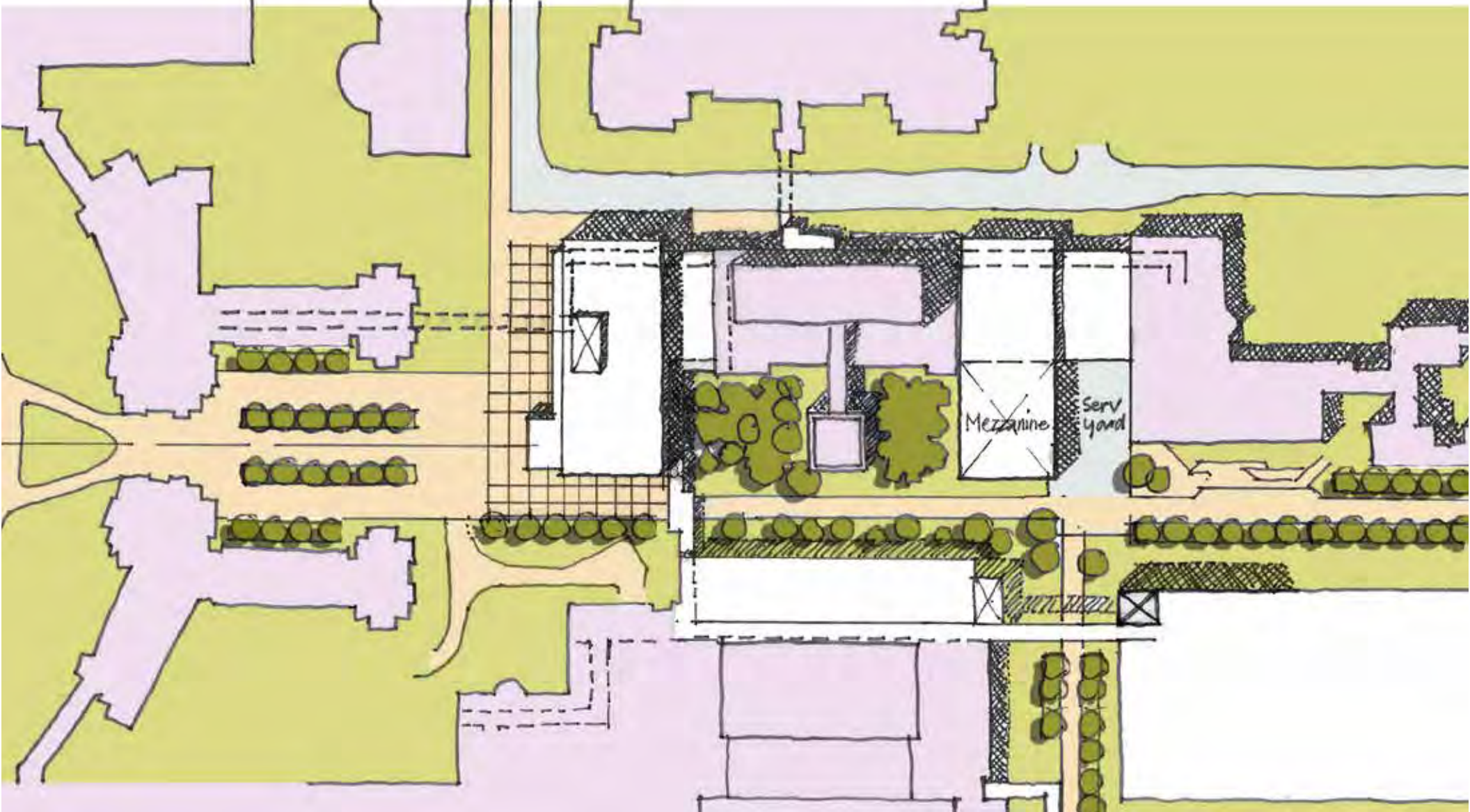

## Exploration: Dining Hall Exploration 4

## Next Steps

- **Submit Phase 2 Questionnaire**
- **Summarize Phase 2 Key Messages**
- **Phase 3: Draft Plan Preparation**
- **Engagement #3: Week of November 30, 2015**
- **Board of Governors Presentation - Draft Plan December, 2015**

# Project Contacts

## Neil Paskewitz, P.Eng.

Director  
Planning, Design & Construction  
Facilities Management  
University of Regina

(306) 585-4648

Neil.Paskewitz@uregina.ca

<http://www.uregina.ca/fm/p-d-c/master-plan2016/index.html>